

MOD.	ΚΑΤΟΨΗ
B701	<p>Floor plan for MOD. B701. The room is rectangular with overall dimensions of 7.00m by 3.00m. A semi-circular entrance is located at the bottom center, with a diameter of 1.00m. Two 100*120 tiles are shown at the bottom edge.</p>
B702	<p>Floor plan for MOD. B702. The room is rectangular with overall dimensions of 7.00m by 3.00m. A semi-circular entrance is located at the bottom center, with a diameter of 1.00m. The room is divided into a main area (4.78m wide) and a bathroom (2.00m wide) on the right. The bathroom contains a toilet, sink, and shower. A 50*50 tile is shown in the bathroom. A door is labeled 70/205.</p>
B703	<p>Floor plan for MOD. B703. The room is rectangular with overall dimensions of 7.00m by 3.00m. A semi-circular entrance is located at the bottom center, with a diameter of 1.00m. The room is divided into a main area (4.78m wide) and a bathroom (2.00m wide) on the left. The bathroom contains a toilet, sink, and shower. A 50*50 tile is shown in the bathroom. A door is labeled 70/205.</p>

B704

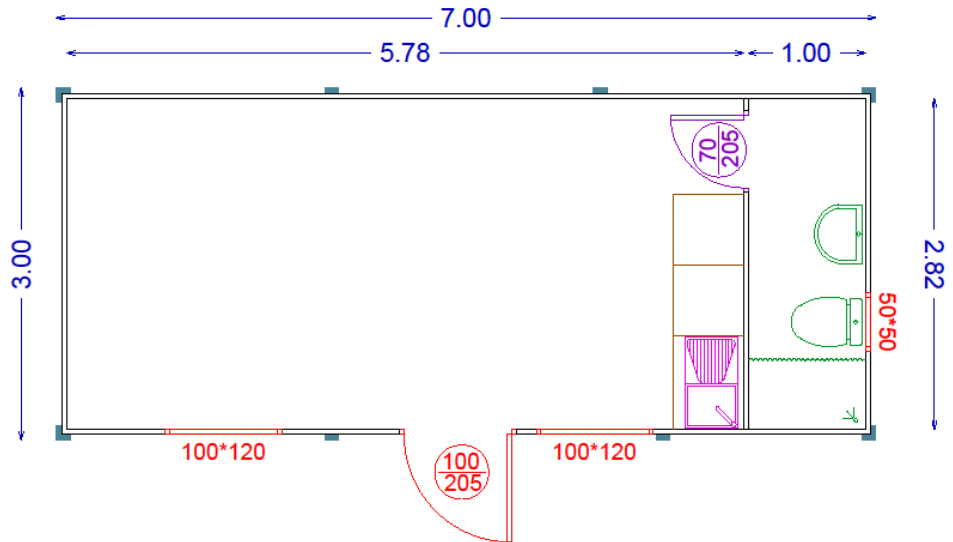

B705

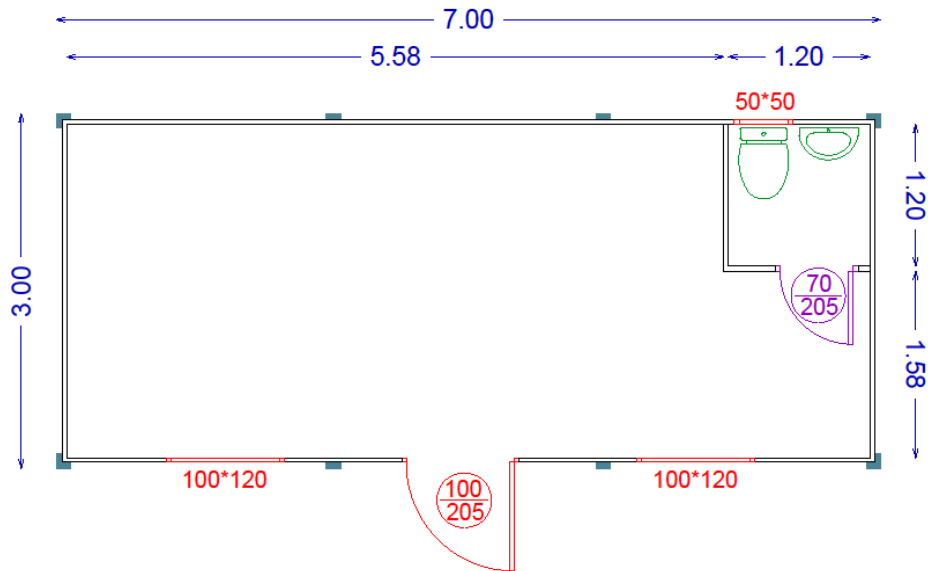

B706

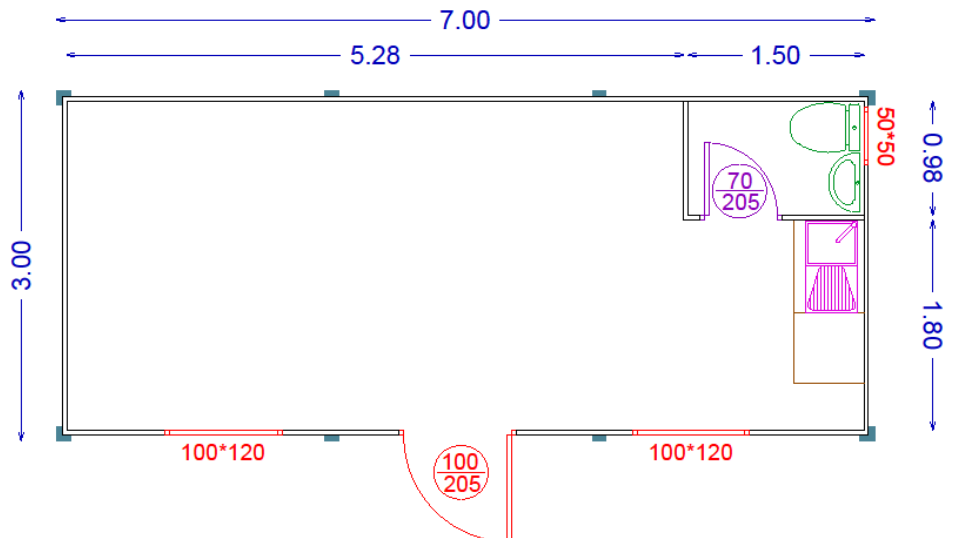

B707

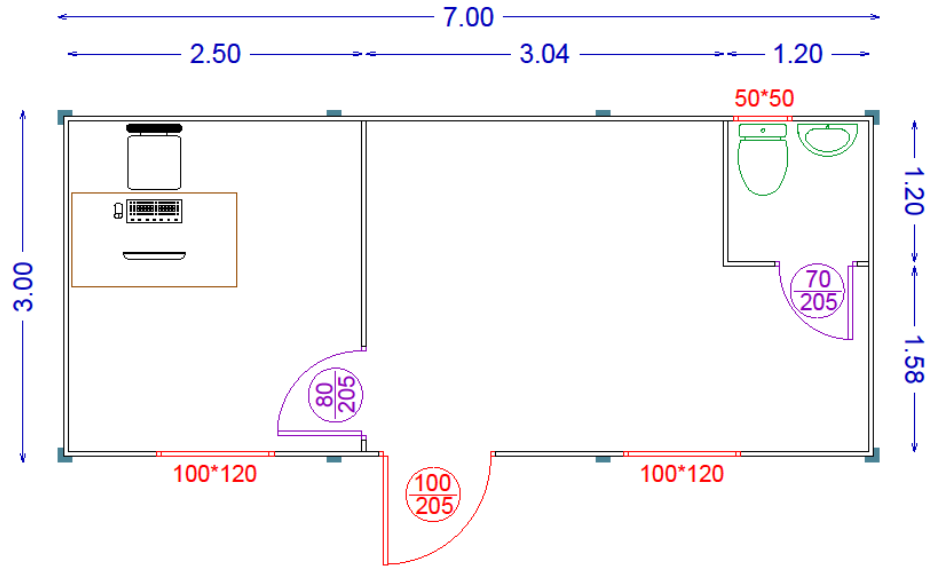

B708

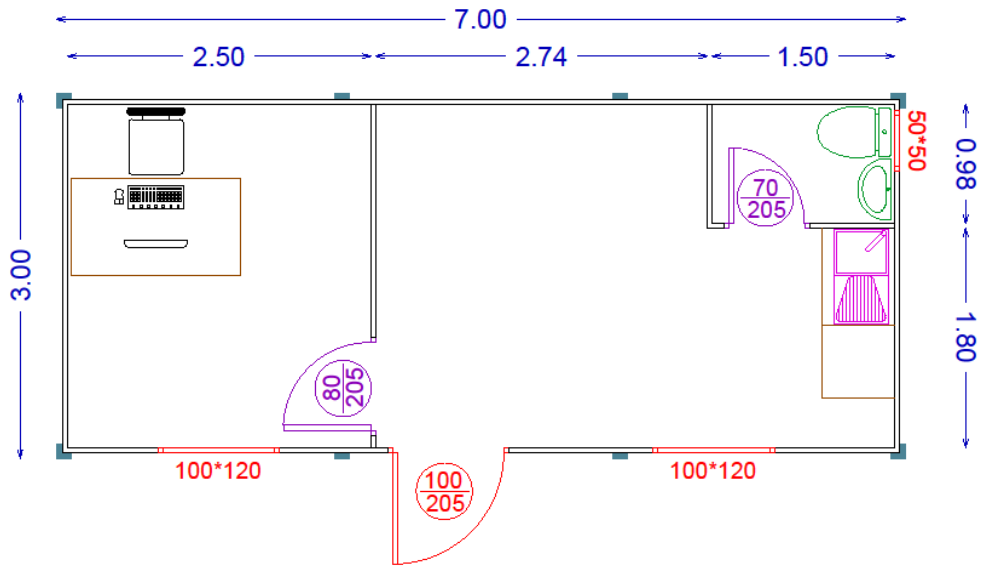

B709

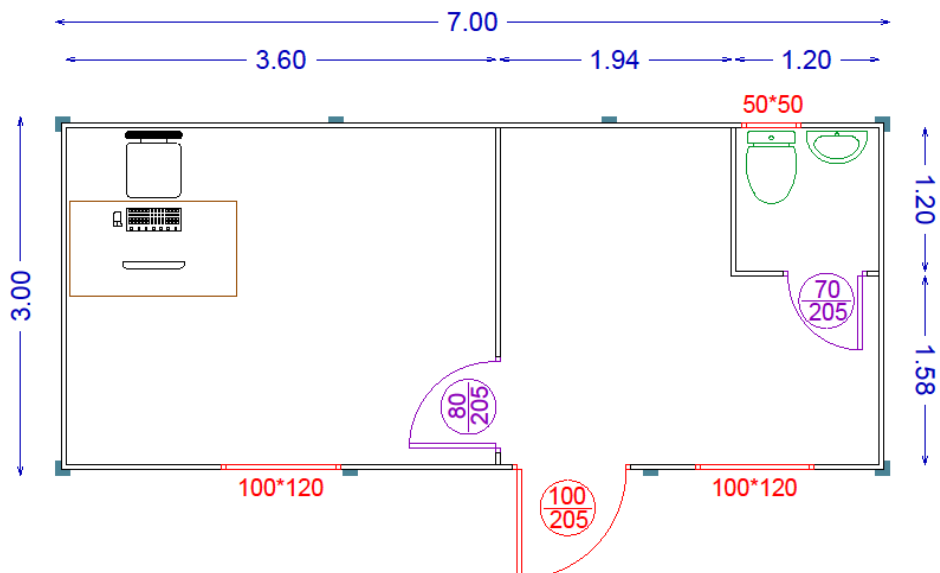

B710

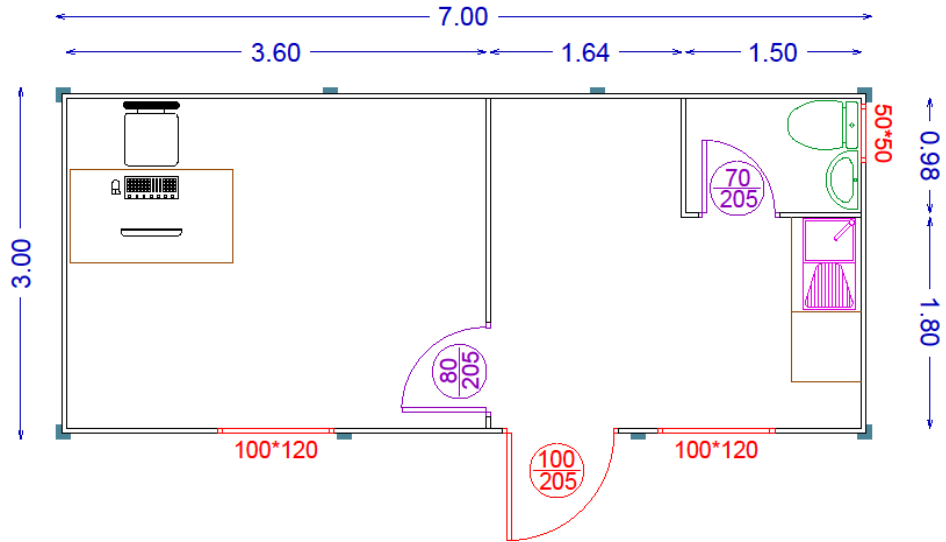

B711

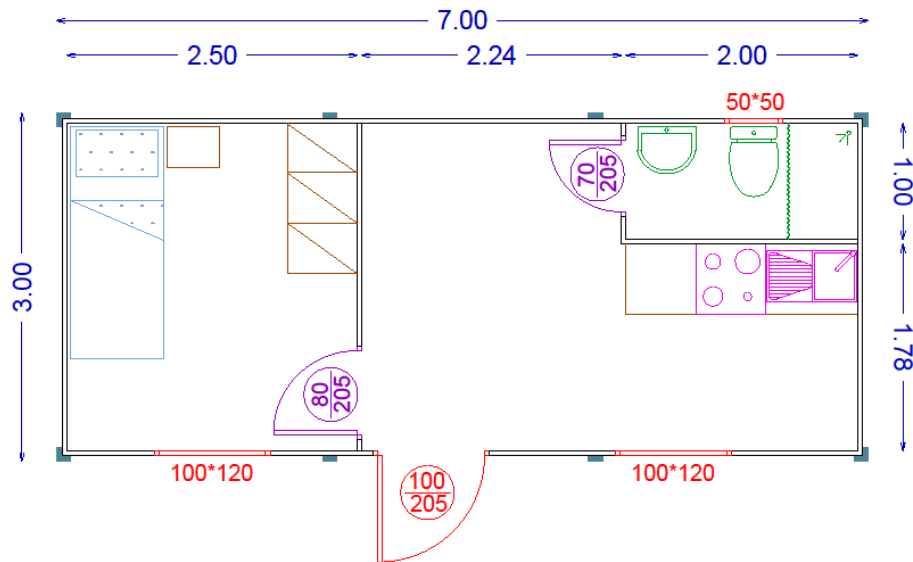

B712

